

Ufi Gel® SC/P · Ufi Gel® hard/C

# Ufi Gel® SC/P · Ufi Gel® hard/C

THE RELINING SYSTEM FOR EVERY CASE OF APPLICATION



**VOCO**  
THE DENTALISTS

# Ufi Gel® SC/P · Ufi Gel® hard/C

## THE RELINING SYSTEM FOR EVERY CASE OF APPLICATION

Age-related atrophy of the jaw-bone, bone loss after extractions and periodontitis routinely lead to a worsening of the fit of partial or full dentures. A reduction in the hold of the dental prosthesis is the consequence, which negatively affects chewing function and phonetics. Furthermore, the wearing comfort is considerably reduced.

In these cases, relining is necessary to adapt the denture to the changes that have occurred in the jaw-bone.

There are several ways to restore the fitting accuracy and thus the correct fit of a total or partial denture.

In addition to indirect relining involving the laboratory, the denture can be relined with a non-hardening or hard material in only one appointment in the surgery. This application saves time and is advantageous, since the patient does not have to go without a denture for extended periods of time and a second appointment is not needed to insert the relined denture.

The Ufi Gel materials have enjoyed success on the market since 1997 and offer the option of carrying out direct relinings, both hard and non-hardening, in only one appointment in the surgery.

### Ufi Gel® SC/P

Ufi Gel SC is the A-silicone-based, non-hardening relining material in the cartridge. Ufi Gel P is the corresponding hand-mix version.

### Ufi Gel® hard/C

Ufi Gel hard is the polymethacrylate-based, hardening, cold-polymerising, permanent denture material. Ufi Gel hard is also available in both cartridges and the hand-mix version.

The Ufi Gel system offers the specific relining solution for every situation. Ufi Gel hard/C and Ufi Gel SC/P form an ideal addition in routine prosthetic work. The Ufi Gel system especially facilitates chair-side relining in only one appointment. After only one visit, the patient leaves the dental surgery with a perfectly relined denture.



# Ufi Gel® SC/P

## PERMANENT, SOFT RELINING MATERIAL

Many things are required from a non-hardening relining material. These are gentleness to the oral mucosa, firm hold on the hard, synthetic base, the ability to remain permanently soft as well as high elasticity and good resilience. In addition, the relining should be smooth and feature easy to polish surfaces with the simplest processing, as well as optimal shade matching and shade consistency. As a non-hardening relining material, Ufi Gel SC/P by VOCO fulfils all of these requirements.

In Ufi Gel SC/P, VOCO offers a top class relining silicone that guarantees both treatment and wearing comfort and permits complete relining in only one appointment.

### The indications

Within the scope of treatments in denture patients, the clinical indications given are for insufficient retention or adhesion of the denture, flabby ridge, decubitus as well as mucosa and jaw treatments. Furthermore, the non-hardening Ufi Gel is indicated for readjustment of the denture and also for support during healing in implantology.

### Straightforward working and strong adhesive bond

Ufi Gel SC's proven cartridge system provides a correct mixing ratio every time and thus enormous savings in material and time with unwavering excellent quality. Ufi Gel SC/P is compatible with all conventional PMMA materials. In combination with the patented adhesive, an extremely strong bond is obtained between the denture and relining material, which provides an exact fit of the denture through its outstanding adaption properties. The relining fabricated with Ufi Gel SC/P can be easily and quickly polished with the polisher included in the set.

### Tissue-friendly, wearing comfort and bacteriostatic

Ufi Gel SC/P is A-silicone-based and thus extremely well tolerated, since no softeners or residual monomers are excreted after setting. Ufi Gel SC/P is tasteless and characterised by an excellent shade match to the denture material and high wearing comfort. The aesthetic appearance of the restoration is created by the translucently pink material that imitates the shade of the surrounding tissue and also does not discolour over time.

The wearing comfort is attained through the outstanding adaption properties on the one hand and high elasticity and excellent resilience on the other. Ufi Gel SC/P remains permanently soft as an A-silicone with a low Shore-A hardness value. The chewing pressure is simultaneously cushioned and distributed over a large area. Ufi Gel SC/P is thus ideally suited for relining in cases involving wounds, e.g., after inserting implants. In the scope of implant therapy, the smooth, pore-free, hydrophobic surface of the A-silicone additionally contributes to success. Ufi Gel SC/P prevents the colonisation by germs and bacteria and thus minimises the risk of wound infections.

### Straightforward fabrication of a non-hardening relining with Ufi Gel®

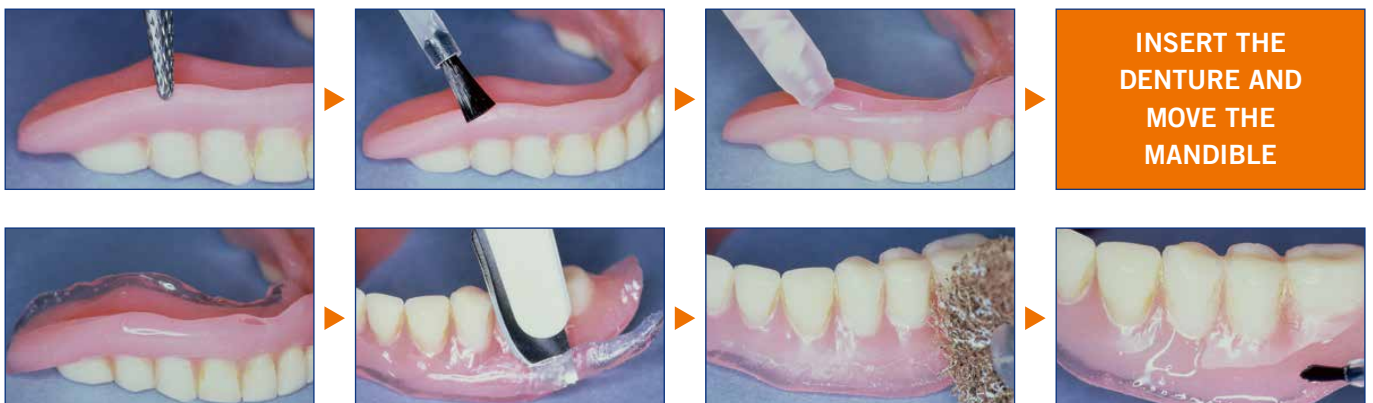

## Ufi Gel® hard/C

### THE HARD RELINING MATERIAL

Every kind of mucosa-borne dental prosthesis requires periodic rechecking. Resorption and reconstruction procedures can cause incongruities between the denture base and mucosa mounting over a long period of time. These often lead to poor fitting of the denture and/or a reduction in retention and overstressed existing tooth abutments as well as pressure spots. The consequences are periodontal damage, functional disturbances, changes in chewing behaviour caused by pain and the patient's general dissatisfaction with his/her denture. Relinings with the purpose of balancing such incongruities thus often ensue as a result of follow-up appointments and are essential for long-lasting prosthetic success.

#### The indications

The indication spectrum covers all hard, permanent relinings of denture base-mucosa mounting incongruities in partial and total dentures as well as valve border changes, for which there is no expansive construction of denture border required. The adjustment is possible in layers over years with Ufi Gel hard/C.

#### The Material

Ufi Gel hard/C is a polymethacrylate-based material similar to denture resin for permanent, hard relinings in only one appointment.

During the development of the hard relining material and optimum coordination of the ingredients, much attention was given to attaining a material with a neutral taste and smell as well as using non-allergenic ingredients.

Ufi Gel hard/C is an MMA-free material. It contains an extremely small amount of monomethacrylate (< 3 % w/w), so that mucosa irritations or contact allergies do not occur. Furthermore, Ufi Gel hard/C does not develop an appreciable increase in temperature during polymerisation.

The simple presentation of Ufi Gel hard C in the cartridge guarantees a homogenous consistency as well as an absolutely bubble-free application of the relining material every time. The two separate delivery outlets of the cartridge prevent an inadvertent reaction of the cartridge contents.

The relining with Ufi Gel hard/C offers a quick and simple alternative to the laboratory relining. Through the direct impression, the relining with Ufi Gel hard/C is very precise and does not differ from a relining fabricated in a commercial laboratory in relation to hardness, handling and cleaning.

#### Straightforward fabrication of a hard relining with Ufi Gel® hard/C

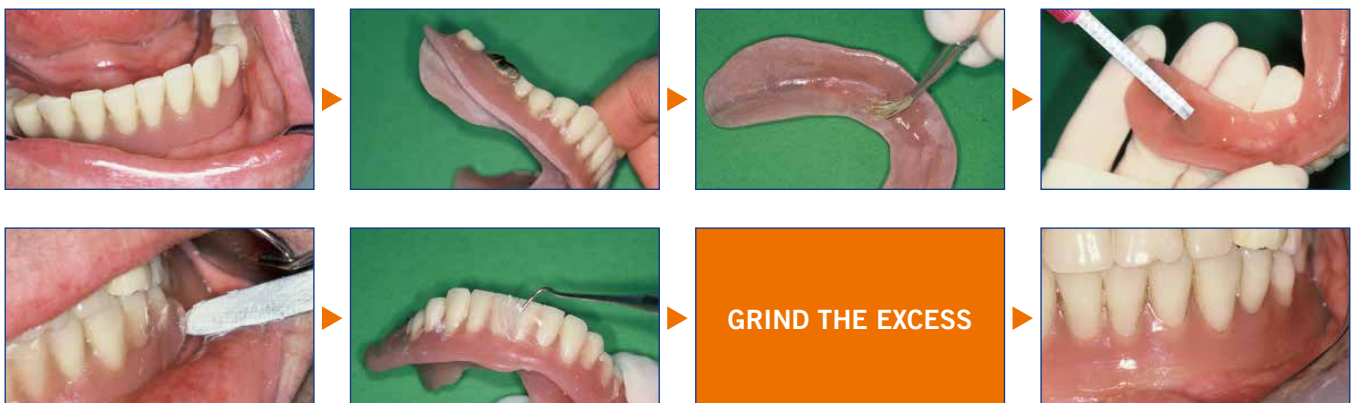

GRIND THE EXCESS

Ufi Gel® SC/P · Ufi Gel® hard/C

RELINING WITH SYSTEM

Use and indication	Ufi Gel® SC/P	Ufi Gel® hard/C
Relining	Non-hardening relining	Hard relining
Durability	Medium-term, 2 weeks to 2 years	Long-term, permanent
<b>General relining</b>		
Total relining	•	•
Partial relining	•	•
Immediate/interim denture	•	
Definitive denture	•	•
<b>For therapy purposes</b>		
In case of pressure sores	•	•
In case of jaw infections	•	
In case of hyperplastic tissue	•	
After operations and wound healing	•	•
After implant treatments	•	
In case of Epitheses	•	
<b>Restoration of the denture</b>		
In case of inadequate retention	•	•
For better wearing comfort	•	•
In case of atrophy	•	•
For adjustment in layers		•
By extending the denture		•
In case of denture stomatitis	•	•
Extending the denture borders	•	•

## Ufi Gel® SC/P · Ufi Gel® hard/C

### THE ADVANTAGES AT A GLANCE

#### Ufi Gel® SC/P

- Time-saving relining in only one appointment
- Neutral taste and odour
- Strong adhesive bond between relining and denture
- Highly aesthetic appearance through shade matching
- Smooth, hydrophobic surface inhibits germ and Candida development
- Easiest cleaning
- High permanent elasticity, resistance to abrasion and tensile strength as well as good dimensional stability
- Positive long-term clinical experience



#### Presentation

##### Ufi Gel® SC

- REF 2041 Set cartridge 50 ml, adhesive bottle 10 ml, glazing base 10 ml, glazing catalyst 10 ml, accessories
- REF 2040 Cartridge 50 ml, accessories
- REF 2029 Adhesive bottle 10 ml
- REF 2047 Glazing bottle 2 x 10 ml (base / catalyst)
- REF 2049 Polishing discs, 10 pcs.
- REF 2158 Dispenser – type 2
- REF 2187 Mixing tips type 8, 50 pcs.

##### Ufi Gel® P

- REF 2070 Set tube base 50 ml, catalyst 50 ml, glazing base 10 ml, glazing catalyst 10 ml, adhesive bottle 10 ml, accessories
- REF 2071 Tube 2 x 50 ml (base / catalyst)
- REF 2076 Adhesive bottle 10 ml
- REF 2077 Glazing bottle 2 x 10 ml (base / catalyst)
- REF 2309 Disposable brushes for dental brush holder, 100 pcs.
- REF 2315 Mixing palettes, 20 pcs.
- REF 2338 Brush holder for VOCO disposable dental brushes and Micro Tim, 5 pcs.

#### Ufi Gel® hard/C

- Complete chair-side relining in only one appointment
- Simple, time- and material-saving application from the cartridge
- Quick and simple polishing
- Durable, strong bond between the lining and the prosthetic material
- No heat development during setting in the oral cavity, thus increased fitting accuracy
- Shade stable and aesthetic



#### Presentation

##### Ufi Gel® hard C

- REF 2215 Set cartridge 80 g, adhesive bottle 10 ml, accessories
- REF 2218 Set + dispenser cartridge 80 g, adhesive bottle 10 ml, accessories
- REF 2216 Cartridge 80 g, accessories
- REF 2217 Adhesive bottle 10 ml
- REF 2158 Dispenser – type 2
- REF 2187 Mixing tips type 8, 50 pcs.

##### Ufi Gel® hard

- REF 2210 Set powder 60 g, liquid bottle 40 ml, conditioner bottle 20 ml, accessories
- REF 2211 Powder 60 g
- REF 2212 Liquid bottle 40 ml
- REF 2213 Conditioner bottle 20 ml

VOCO GmbH  
Anton-Flettner-Straße 1-3  
27472 Cuxhaven  
Germany

Freecall: 00 800 44 444 555  
Fax: +49 (0) 4721-719-140

info@voco.com  
www.voco.dental

Available from:

