

Take 1®. Easy. Precise. Versatile. Hydrophilic.



PRECISION IMPRESSION MATERIAL



Case courtesy of Dr. Christopher Pescatore



The closer you look, the better we look.

- **Multiple choice.** 5 viscosities, 3 set times and 3 delivery methods, including unique Unidose® syringe for wash.
- **Proprietary blend of 5 vinyls.** Combines with Kerr's advanced ultra-fine particle filler to provide tensile strength and stretch to flex around undercuts.
- **Marginal integrity.** Optimal elongation and tear strength properties deliver enhanced marginal integrity.
- **Patented hydrophilic additive.** Provides excellent surface energy, resulting in unsurpassed reproduction accuracy even in the presence of moderate blood and saliva.
- **Contact angle.** Low contact angle releases the surface tension of intraoral fluid, causing it to be dispersed.

Explore the science of Kerr at www.KerrHawe.com • www.KerrDental.com

Take 1. The most comprehensive family of VPS materials.

Take 1[®] raises the standard for vinylpolysiloxane (VPS) impression materials to the highest degree. With a proprietary blend of five vinyls, a bimodal filler system, patented surfactant and hydrophilic modifier, this unique material works consistently and easily in virtually any impression-taking situation, delivering detail that makes a difference.

Take 1's bimodal filler system provides optimal dispensing viscosity without slumping in the tray or dripping from the prepared teeth. These thixotropic properties result in superior handling and intraoral performance. The material's outstanding marginal reproductions lead to accurate results from every impression.

- **Bright, easy-to-read colours.** Helps the dentist double-check for detail, accuracy and any possible defects.
- **Optimal thixotropic properties.** Flows easily and deeply into the sulcus, without dripping or slumping.
- **Outstanding fluid displacement.** Patented surfactant and hydrophilic modifier work synergistically to displace oral fluids trapped in the sulcus, minimising the possibility of voids that could compromise marginal integrity.

Indications: Suitable for all crown and bridge, edentulous and implant impressions.

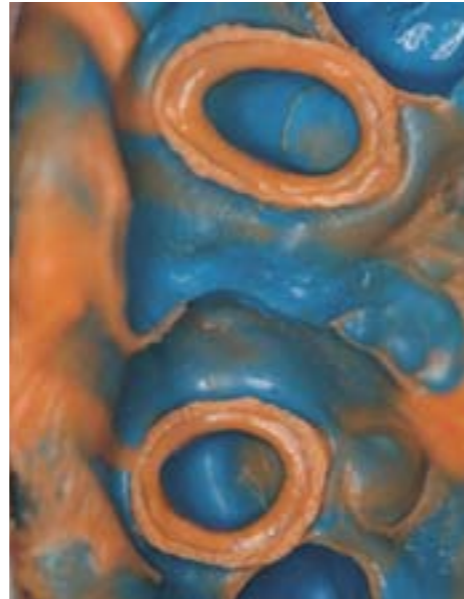

Unidose[®] syringe delivery option provides enough wash material for 1 to 3 units and eliminates cross-contamination concerns.

TAKE 1 IMPRESSION MATERIALS	SET TIMES*			DELIVERY OPTIONS				
	Viscosity	Regular	Fast	SuperFast	Unidose	Automix Cartridge	Volume Foil	Jar
Unit Volume					2 ml	50 ml	362 ml**	800 g**
Work Times (± 0:15 minute)		2:00	1:30	1:00				
Total Set Times (minutes)		5:00	4:00	2:30				
Wash	Low	•	•	•	•	•		
Medium/Monophase	Medium	•	•	•		•		
Tray	High	•	•	•		•	•	
Rigid Tray	High		•			•		
Putty	High		•					•

*Not all set times are available in each delivery system. **Mixed paste total volume.

UNIDOSE SYRINGE ACTIVATION

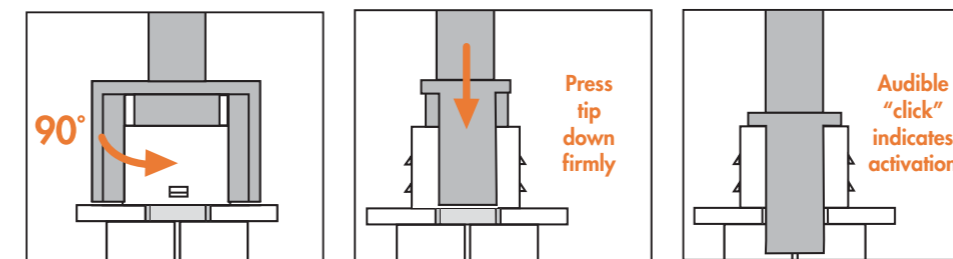

1. Twist tip 90 degrees.
2. Press tip down firmly through notch until "click" is heard. Material is now ready to dispense.

Take 1 gives you a choice of five viscosities of precision impression material.

Take 1 Wash. Low-viscosity syringe material that flows easily without dripping. Its hydrophilic property ensures amazing detail even in the presence of moderate blood or saliva, and its bright orange colour makes marginal detail easier to see.

Take 1 Medium/Monophase. Can be used as a syringe or tray material. It is an excellent choice for denture impressions and perfect for the dentist who prefers a more thixotropic syringe material.

Take 1 Tray. Non-slumping tray material that's easy to remove from the mouth while consistently delivering distortion-free impressions. It is versatile enough for quadrant or full-arch impression trays.

Take 1 Rigid Tray. A considerably firmer tray material with a slightly higher durometer than Take 1 Tray. Rigid Tray is designed to compensate for impression trays that can cause distortion. When the triple-tray technique is used, Rigid Tray is firm enough to keep the tray from distorting yet is flexible enough for easy, distortion-free removal.

Take 1 Putty. High-viscosity material that is indicated for both simultaneous and two-step putty/wash techniques. Its thixotropic nature will drive syringe material subgingivally and displace the tissue to provide accurate marginal details. With an ideal durometer, the final set is firm yet easy to remove from the mouth.

Preliminary impression material.

Take 1 Alginate. Combines clinical versatility with exceptional ease of use. Its chromatic colour-change property ensures timely procedure control, and its elasticity, dimensional stability, accurate detail reproduction and 120-hour (at 100% humidity) pouring time provide consistently reliable results.

"Take 1 is a material with a high percentage of elongation and an equally high recovery from deformation, which means easy removal from the oral cavity. The hydrophilic additive creates an extremely low contact angle, which can displace fluids in critical areas such as the gingival sulcus of each prep."

– Dr. Robert A. Lowe
Charlotte, NC, USA

TENSILE ELONGATION (%)

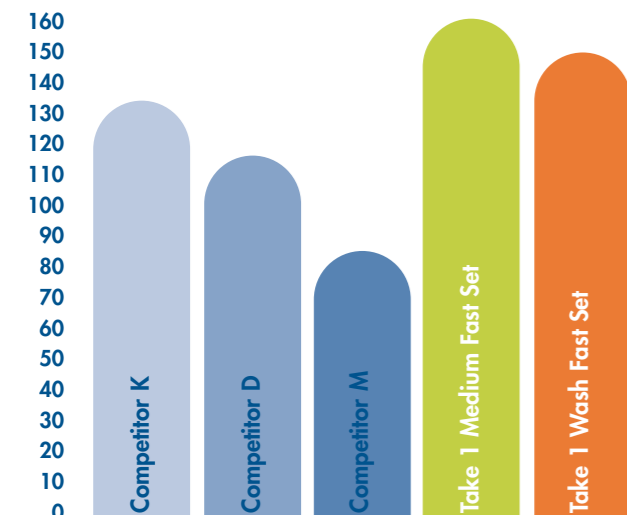

Take 1's high percentage of elongation gives it considerable flex to stretch around undercuts without tearing or deforming.

CONTACT ANGLES

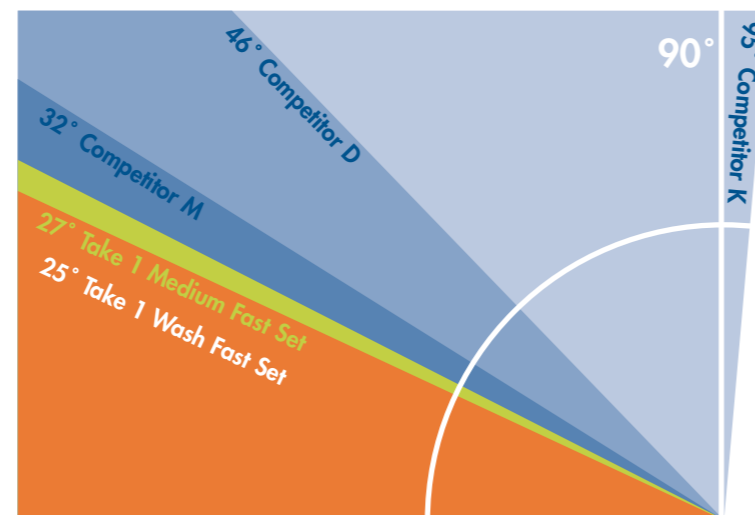

The lower the contact angle, the greater the "wettability," which allows displacement of oral fluids for a more detailed impression.

Test results provided by the Dental Materials Center.

Take 1. Viscosities, set times and delivery options to match your needs.

Take 1® is available in five viscosities and a variety of set times. Three delivery options are also available, making it the most complete impression material available today. The 5-vinyl blend within each viscosity provides incredible physical tear strength, optimal flow and elastomeric properties that ensure a high percentage of elongation for accurate results, every time. With proper soft-tissue management, Take 1 will give you a highly detailed reproduction without rebound or distortion. If you prefer a more rigid material, Take 1 Rigid Tray gives you the rigidity you're looking for without the high durometer of competitive materials.



Order Information

Take 1 Unidose Intro Kits

- 33181 Fast Set
- 33262 Regular Set

Kits contain:

- 4 Unidose Syringes Wash (2 ml each)
- 1 Cartridge Wash (50 ml)
- 3 Cartridges Tray (50 ml each)
- 12 Mixing Tips

Take 1 Unidose Refill Kits

- 33183 Fast Set
- 33245 Regular Set

Kits contain:

- 12 Unidose Syringes Wash (2 ml each)

Take 1 Unidose Bulk Packs

- 33184 Fast Set
- 33341 Regular Set

Packs contain:

- 4 Unidose Syringe Refill Kits (48 syringes/Bulk Pack)

Take 1 Volume Intro Kits

- 33186 Fast Set
- 33246 Regular Set

Kits contain:

- 1 Base (300 ml)
- 1 Catalyst (62 ml)
- 6 Unidose Syringes Wash (2 ml each)
- 1 Reusable Cartridge
- 10 Dynamic Volume Mixing Tips

Take 1 Volume Refill Kits

- 33185 Fast Set
- 33247 Regular Set

Kits contain:

- 2 Base (300 ml each)
- 2 Catalyst (62 ml each)

Take 1 Alginate

- 33342 1 Jar (500 g) and
1 Powder & Liquid Measures
- 33343 20 Bags (450 g) and
5 Powder & Liquid Measures

Take 1 Mini Kits

- 33187 Fast Set
- 33244 Regular Set

Kits contain:

- 3 Unidose Syringes Wash (2 ml each)
- 2 Cartridges Tray (50 ml each)
- 6 Mixing Tips

Take 1 Putty Intro Kit

- 32240 Fast Set

Kit contains:

- 1 Jar Putty Base (200 g)
- 1 Jar Putty Catalyst (200 g)
- 2 Putty Scoops
- 1 Cartridge Wash (50 ml)
- 18 Putty Spacers
- 6 Mixing Tips
- 6 Intraoral Tips

Take 1 Putty Refill Pack

- 32191 Fast Set

Pack contains:

- 1 Jar Putty Base (400 g)
- 1 Jar Putty Catalyst (400 g)
- 2 Putty Scoops
- 18 Putty Spacers

Take 1 32-Cartridge Bulk Packs*

- 29173 Tray, Regular Set
- 29289 Tray, Fast Set
- 32016 Tray, SuperFast Set
- 29176 Wash, Regular Set
- 29179 Wash, Fast Set
- 32013 Wash, SuperFast Set
- 29292 Medium/Monophase, Reg Set
- 29334 Medium/Monophase, Fast Set
- 31999 Medium/Monophase, SuperFast Set
- 29182 Rigid Tray

Bulk Packs contain:

- 16 2-Packs (each 2-Pack contains two 50 ml Cartridges and 6 Mixing Tips)

*SuperFast available upon special order

Take 1 2-Cartridge Refill Packs*

- 29174 Tray, Regular Set
- 29290 Tray, Fast Set
- 32014 Tray, SuperFast Set
- 29177 Wash, Regular Set
- 29180 Wash, Fast Set
- 32011 Wash, SuperFast Set
- 29293 Medium/Monophase, Reg Set
- 29335 Medium/Monophase, Fast Set
- 31997 Medium/Monophase, SuperFast Set
- 29183 Rigid Tray

Packs contain:

- 2 Cartridges (50 ml each)
- 6 Mixing Tips

Take 1 Bite Refill

- 30953 2-Cartridge Refill

Contains:

- 2 Cartridges (50 ml each)
- 6 Mixing Tips

Take 1 Bite Bulk Pack

- 30954 32-Cartridge Bulk Pack

Bulk Pack contains:

- 16 2-Packs (each 2-Pack contains two 50 ml Cartridges and 6 Mixing Tips)

Take 1 Accessories and Refills

- 33171 Volume Mixer
- 32503 Cartridge for Volume, (reusable)
- 32502 Dynamic Volume Mixing Tips (50 tips)
- 28747 Extruder
- 29363 Mixing Tips, Small/Yellow (48 tips)
- 29333 Mixing Tips, Large/Teal (48 tips)
- 27517 Intraoral Tips, Small (100 disposable)
- 20731 Intraoral Tips, Large (100 disposable)
- 16622 V.P.S. Adhesive (15 ml bottle)
- 09526 Putty Spacers (pkg of 18)



SYBRON DENTAL SPECIALTIES

KerrHawe SA Via Strecce 4, P.O. Box 268, 6934 Bioggio, Switzerland freephone 00800 41 05 05 05 fax +41 91 610 05 14 www.KerrHawe.com www.KerrDental.com